



Gebrauchsanleitung

Komfort-Schiebe-Befestigung
mit Druckschloß

Instructions for use

Comfort sliding fitting
with push button lock

Instructions d'utilisation

Montage glissé facile
avec la serrure de pression

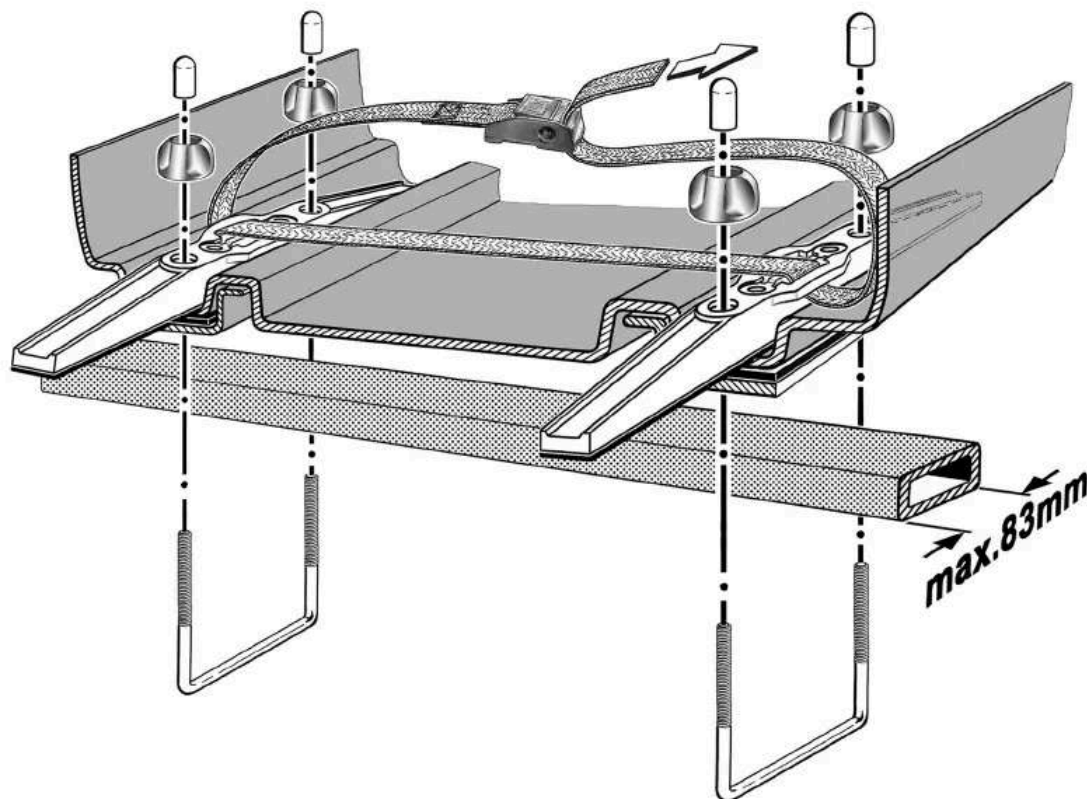
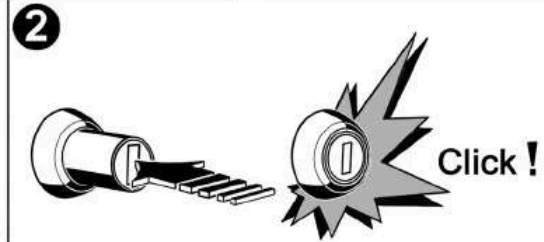
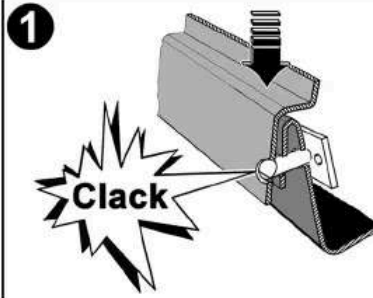
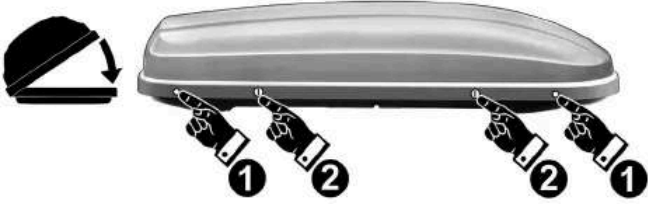
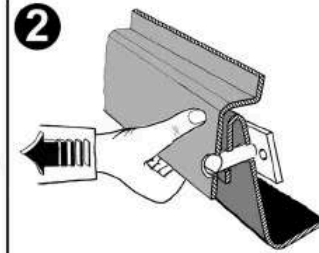
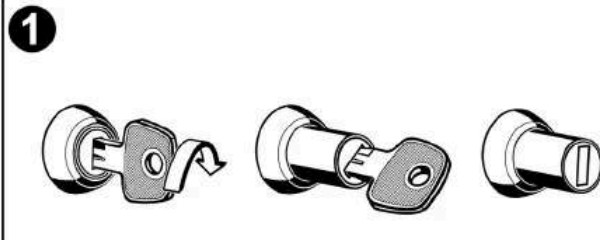
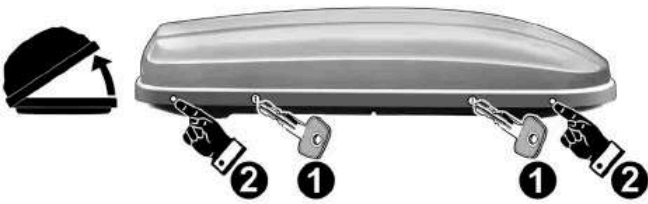
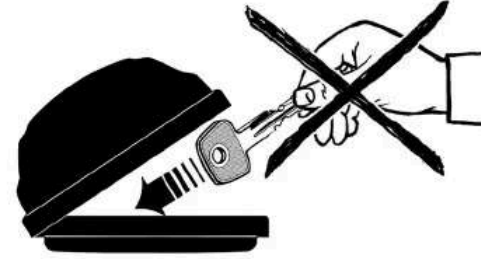
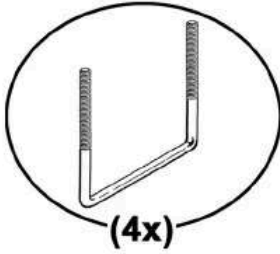

Art.-Nr. 0 52003 10

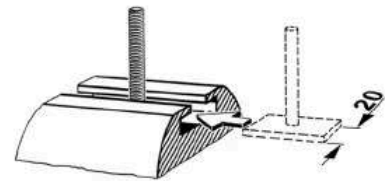

Art.-Nr. 0 52004 10

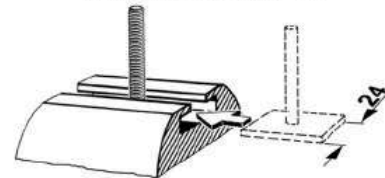

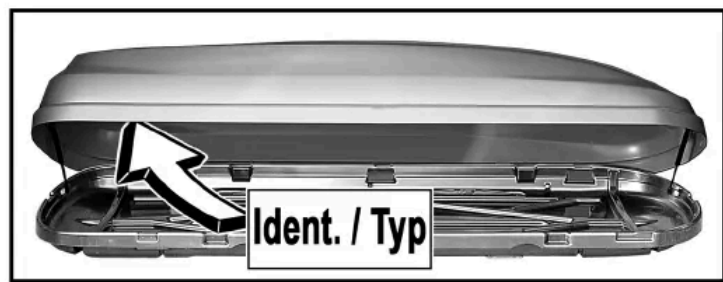
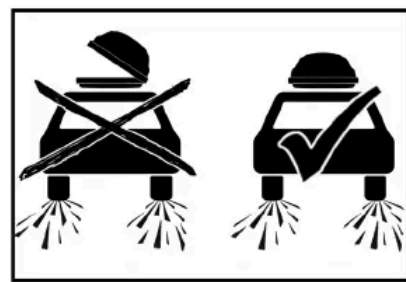
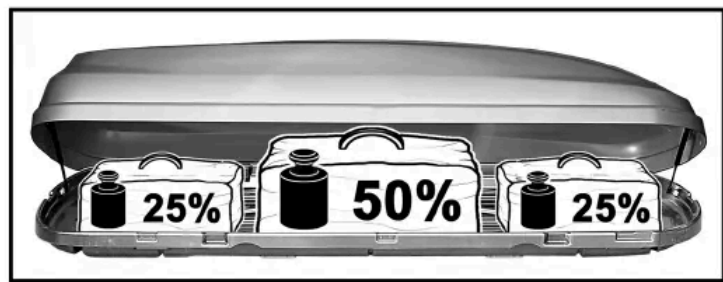
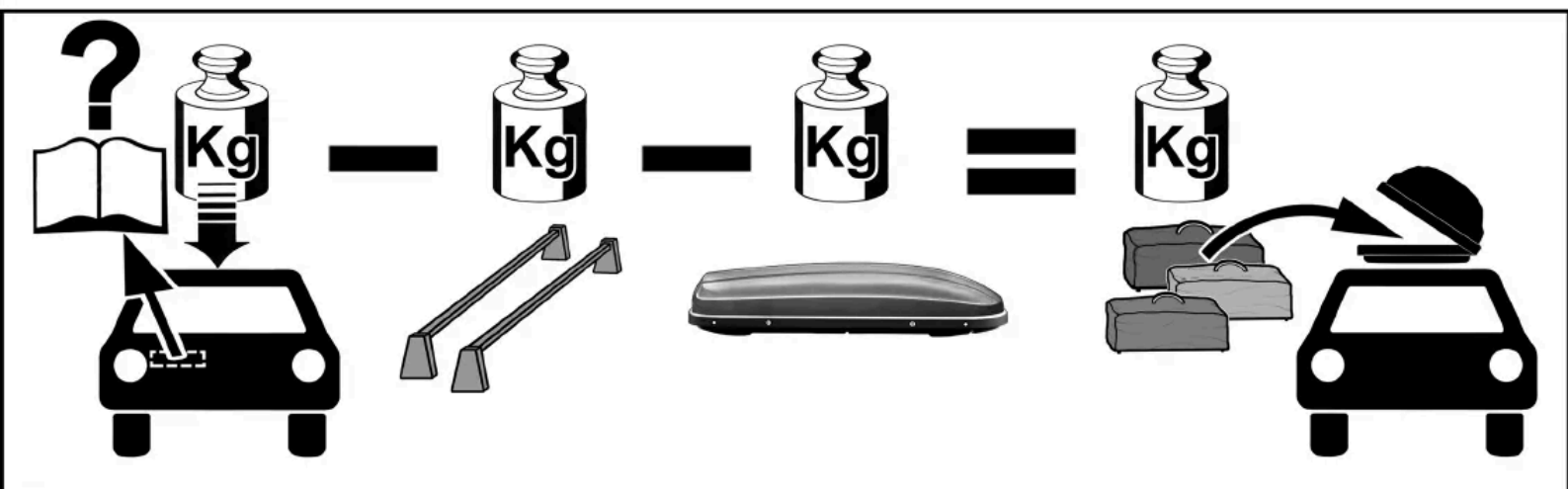
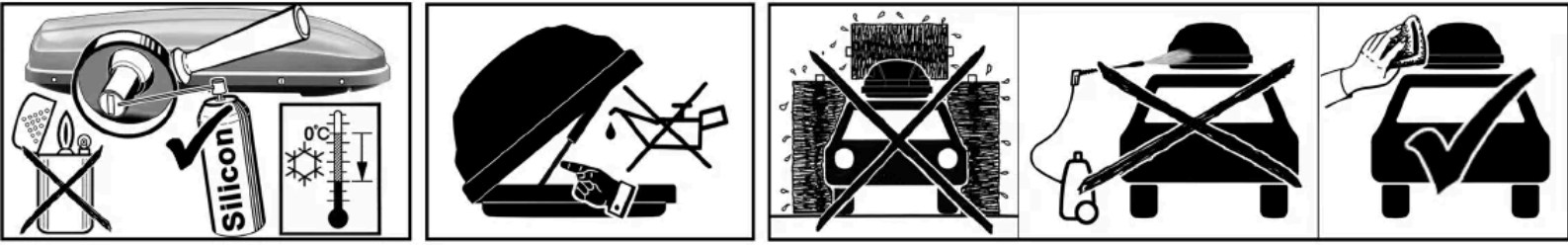
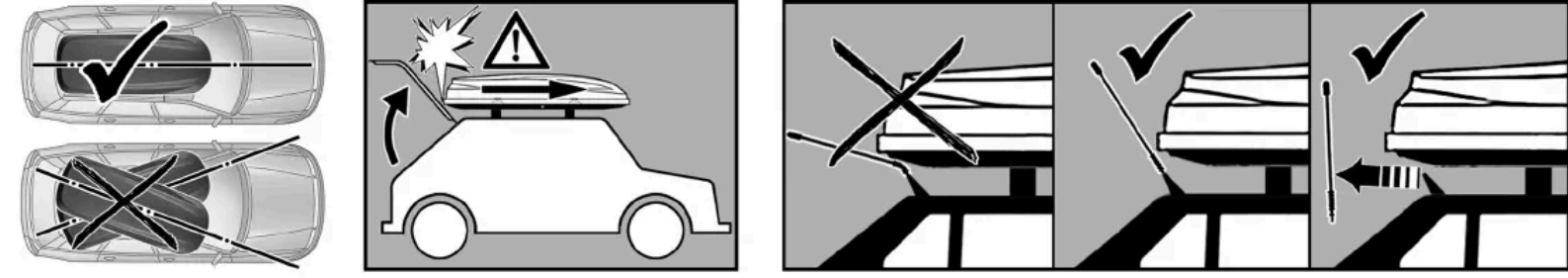

Dachcontainer Typ 81200

Haupt-Verkaufsbezeichnung Auch andere Verkaufsbezeichnungen sind genehmigt	Maße			Volumen	Gewichte		
	Länge cm	Breite cm	Höhe cm	Schüttgut Liter	Eigengewicht kg	zulässige Tragfähigkeit kg	Maximalgewicht beladen kg
Delphin 340 K	190	75	40	340	16	50	66
Husky L	190	75	38	330	13	50	63
Delphin 470	230	75	40	470	19	50	69
Kamei 450	220*	82	38	450	19	50	69
Kamei 300	220*	62	35	300	14	50	64
Delphin 380	158	94	40	380	16	50	66

* Für den Transport von Ski sind Skihalter-Einsätze gesondert lieferbar

* Special ski holders are available for the transportation of skis.

* Pour le transport de skis, des éléments porte-ski sont livrables séparément.

Hersteller: KAMEI 01805 - 26 34 46